



AECOM  
DOUGLAS BUSINESS CENTRE  
CARRIGALINE ROAD  
DOUGLAS  
CORK  
Tel: +353 (0)21 436 5006  
www.aecom.com

1. THIS DRAWING IS TO BE READ IN CONJUNCTION WITH ALL OTHER RELEVANT ENGINEERING DRAWINGS, ANY DISCREPANCIES, ERRORS OR OMISSIONS TO BE BROUGHT TO THE ATTENTION OF THE EMPLOYER.
2. ALL DIMENSIONS TO BE CHECKED BY THE CONTRACTOR ON SITE PRIOR TO COMMENCEMENT OF WORKS.
3. EMPLOYER'S REPRESENTATIVE TO BE INFORMED BY THE CONTRACTOR OF ANY DISCREPANCIES PRIOR TO THE COMMENCEMENT OF WORKS ON SITE.
4. DIMENSIONS OF ALL BOUNDARIES AND ADJOINING ROADS TO BE CHECKED ON SITE PRIOR TO COMMENCEMENT OF WORKS.
5. DO NOT SCALE. ALL MEASUREMENTS AND COORDINATES TO BE CHECKED ON SITE.
6. EXISTING FENCE LINES ARE INDICATIVE AND ARE TO BE CONFIRMED ON SITE. EXISTING FENCING IS TO BE REVIEWED ON SITE AND REPLACED WHERE REQUIRED.
7. EMERGENCY ACCESS POINTS ARE TO BE CLOSED OFF WITH DEMOUNTABLE BOLLARDS. KEYS TO BE HANDED OVER TO THE OVERSEEING ORGANISATION.
8. EGREENWAY DRAINAGE IS TO BE OVER THE EDGE DRAINAGE.
9. PROPOSED FENCELINE TO BE ERECTED IN ACCORDANCE WITH TII STANDARD DETAIL CC-SCD-00303.

| I/R | DATE     | DESCRIPTION         |
|-----|----------|---------------------|
| 2   | DEC 2023 | ABP RFI UPDATE      |
| 1   | MAY 2023 | ABP RFI UPDATE      |
| 0   | OCT 2021 | ISSUED FOR PLANNING |

60617025

PLAN AND PROFILE  
LACKEN  
SHEET 3 OF 18

60617025\_SHT\_DD\_BLGWY\_146.3

ORDNANCE SURVEY IRELAND LICENCE NO CYAL50317588  
© ORDNANCE SURVEY IRELAND / GOVERNMENT OF IRELAND

ISO A1 594mm x 841mm  
Approved: EOM  
Checked: MC  
Designer: CL  
Project Management Initials:

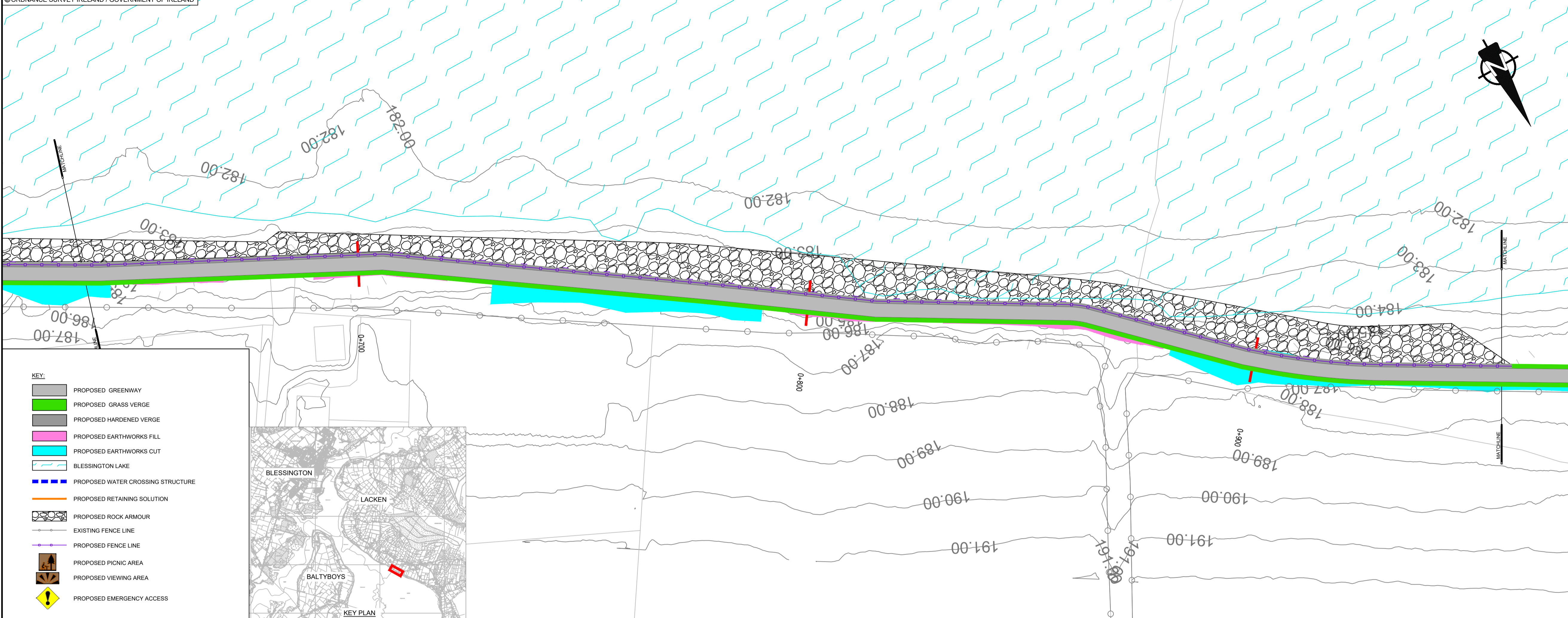

**KEY:**

- PROPOSED GREENWAY
- PROPOSED GRASS VERGE
- PROPOSED HARDENED VERGE
- PROPOSED EARTHWORKS FILL
- PROPOSED EARTHWORKS CUT
- BLESSINGTON LAKE
- PROPOSED WATER CROSSING STRUCTURE
- PROPOSED RETAINING SOLUTION
- PROPOSED ROCK ARMOUR
- EXISTING FENCE LINE
- PROPOSED FENCE LINE
- PROPOSED PICNIC AREA
- PROPOSED VIEWING AREA
- PROPOSED EMERGENCY ACCESS

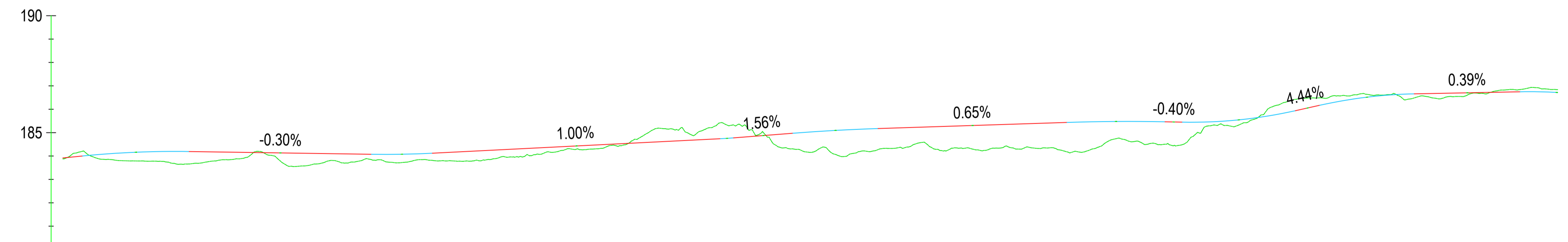

| CHAINAGE           | 640.000                       | 650.000 | 700.000                         | 750.000 | 800.000                      | 850.000 | 900.000                       | 950.000 | 960.000                       |  |
|--------------------|-------------------------------|---------|---------------------------------|---------|------------------------------|---------|-------------------------------|---------|-------------------------------|--|
| EXISTING LEVELS    | 183.875                       | 183.854 | 183.705                         | 184.297 | 184.156                      | 184.351 | 186.175                       | 186.847 | 186.838                       |  |
| PROPOSED LEVELS    | 183.917                       | 184.098 | 184.093                         | 184.430 | 185.027                      | 185.404 | 185.781                       | 186.740 | 186.715                       |  |
| VERTICAL ALIGNMENT | G=1.99%<br>L=22.81<br>K=10.00 |         | G=-0.30%<br>L=13.036<br>K=10.00 |         | G=1.00%<br>L=2.788<br>K=5.00 |         | G=0.65%<br>L=18.22<br>K=20.00 |         | G=0.40%<br>L=20.98<br>K=20.00 |  |

This drawing has been prepared for the use of AECOM's client. It may not be used, modified, reproduced or relied upon by third parties, except as agreed by AECOM, and denies any liability whatsoever. To any party that uses or relies on this drawing without AECOM's express written consent. Do not scale this document. All measurements must be obtained from the stated dimensions.